

How to download data from an Approved CP

An approved Data Export Request is required to download CHILD data

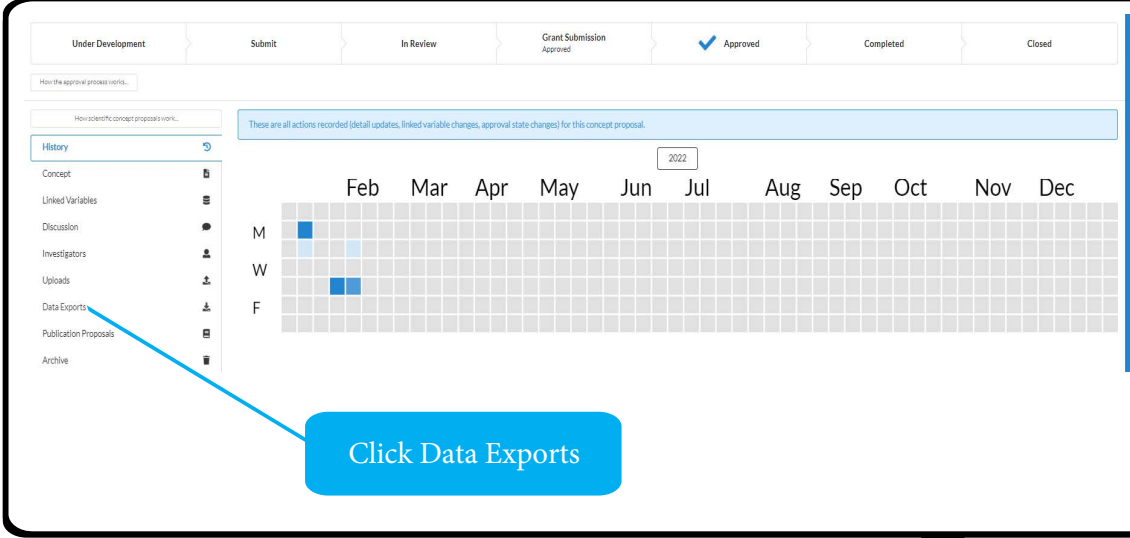

1.

Once a CP is Approved and all conditions of access have been met (fees, MITA, ethics), a default Data Export file is automatically generated. The Default Data Export file contains data for all linked variables in the CP.

From within the CP, click the Data Exports tab to see a list of all the Data Exports associated with the CP.

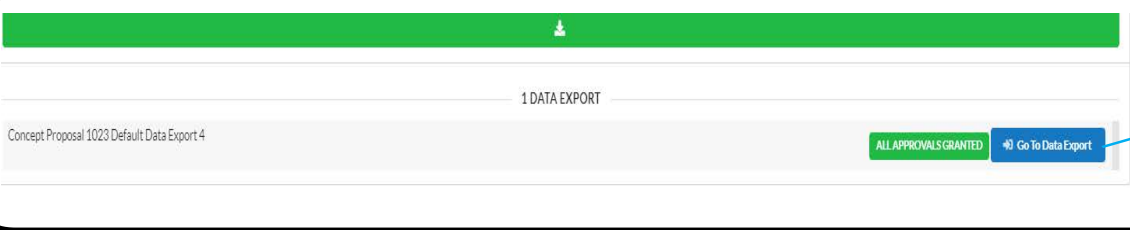

2.

Click the blue button '**Go to Data Export**' to go to the Default Data Export page.

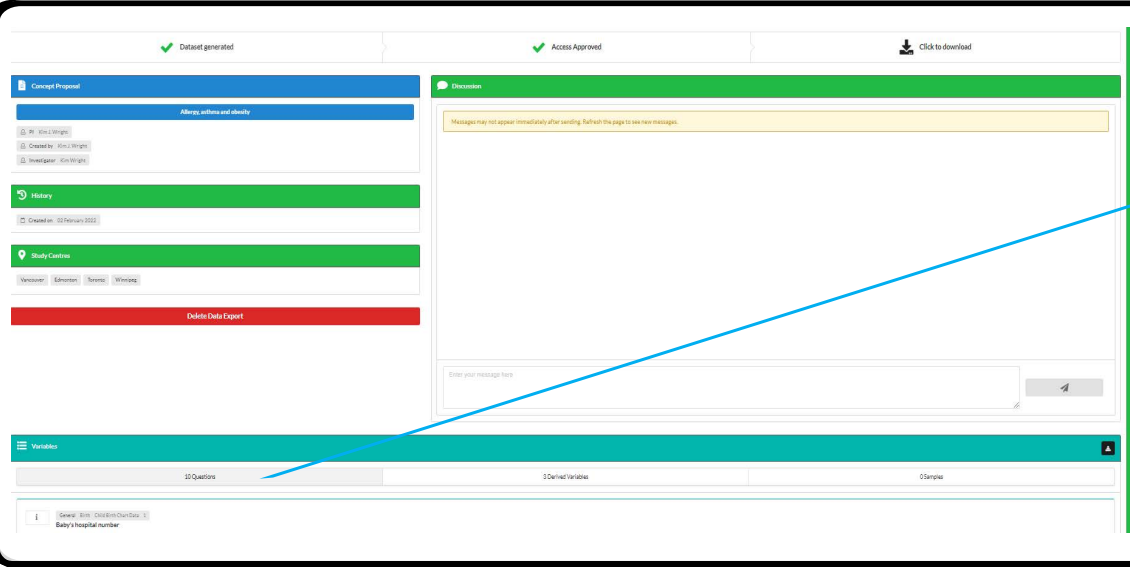

3.

The Data Export page shows information about the dataset including the linked variables.

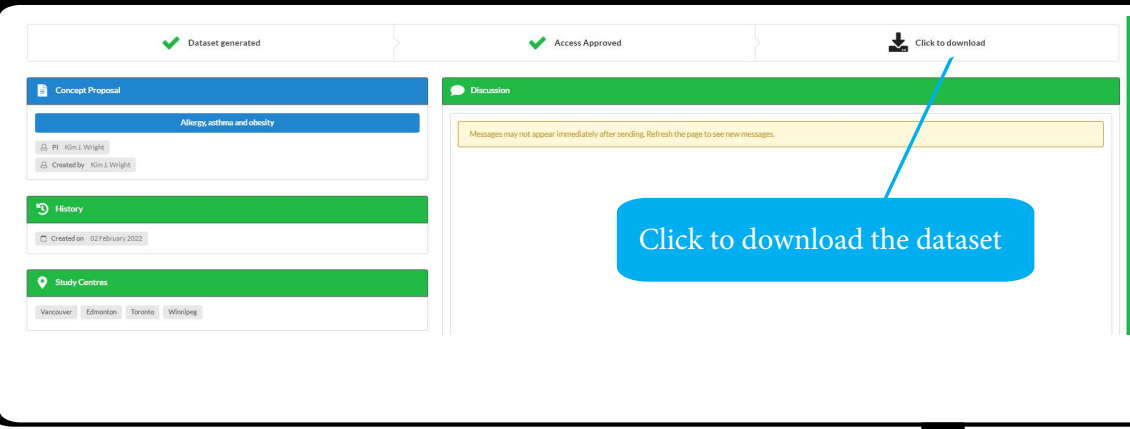

4.

The PI of the CP is approved to download the Default Data Export and any other data exports associated with the CP.

PI's may select **Click to Download** to download the dataset.

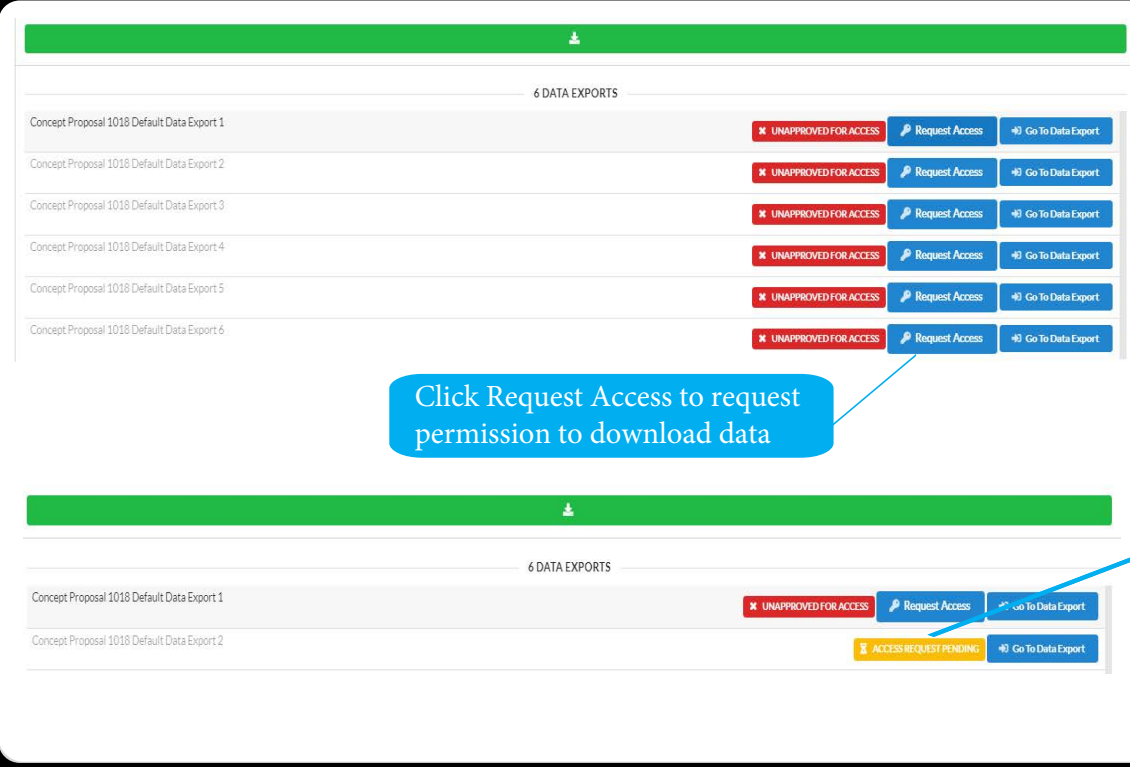

5.

A co-investigator of a CP must request access to download a Default Data Export or any other data export. A green, red or yellow label indicates which Data Exports are approved for a co-I to download.

To request permission to download a dataset, click the blue **Request Access** button.

A yellow alert indicates the request is pending. When a co-I is approved or denied access to a dataset, the co-I will receive an email and a notification in CHILddb.

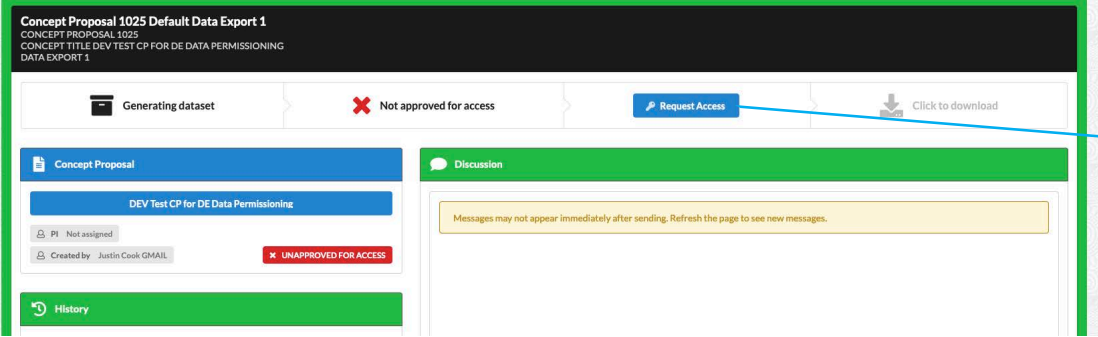

6. Co-I's can also request access from within a specific Data Export page by clicking the blue **Request Access** button.

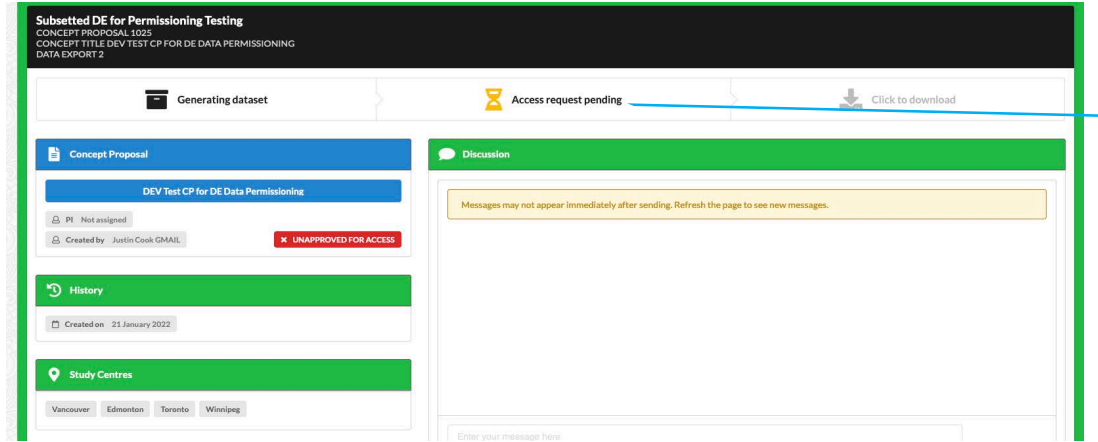

7. A yellow alert indicates the request is pending. When a co-I is approved or denied access to a dataset, the co-I will receive an email and a notification in CHILddb.

For questions about downloading data, contact child@mcmaster.ca.

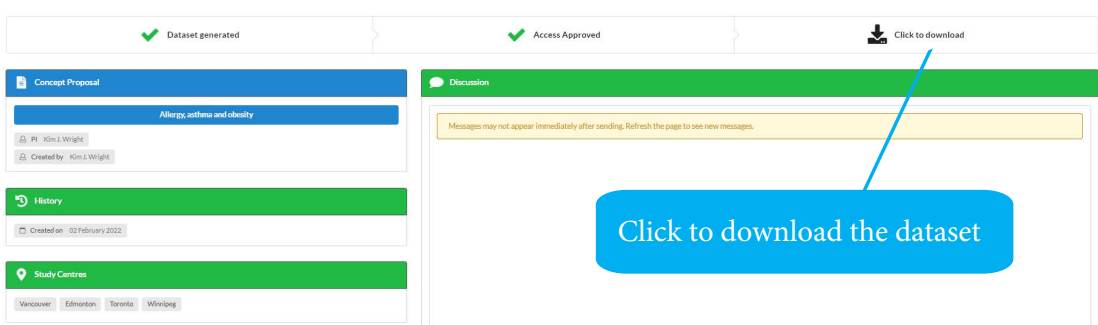

8. Once approved, a co-I may select **Click to Download** to download the dataset.

View Data Export Requests

An approved Data Export Request is required to download CHILDb data

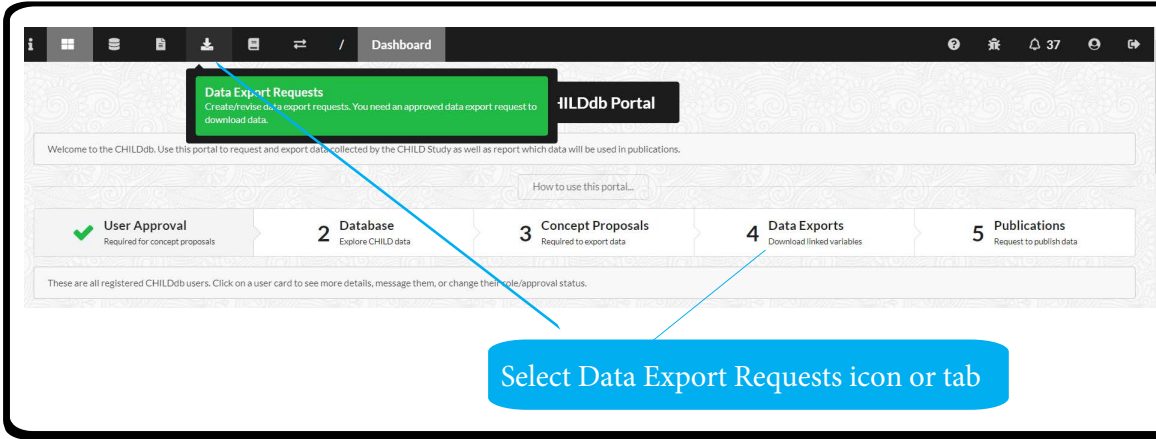

9. From the CHILDb Dashboard, select the **Data Export Requests** icon or tab.

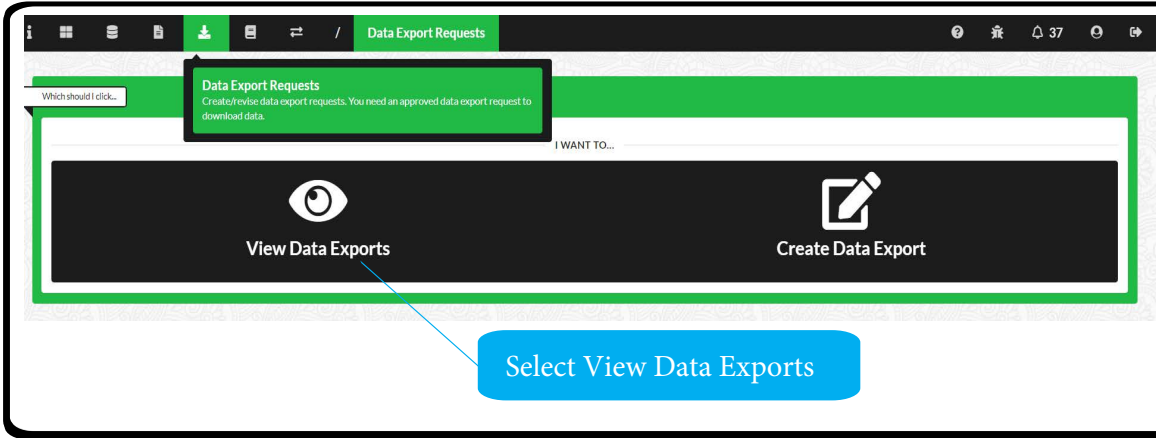

10. You have two options to select from:

- **View Data Exports**
- **Create Data Export**

Select **View Data Exports** to see all the Data Export Requests for the CPs you are associated with.

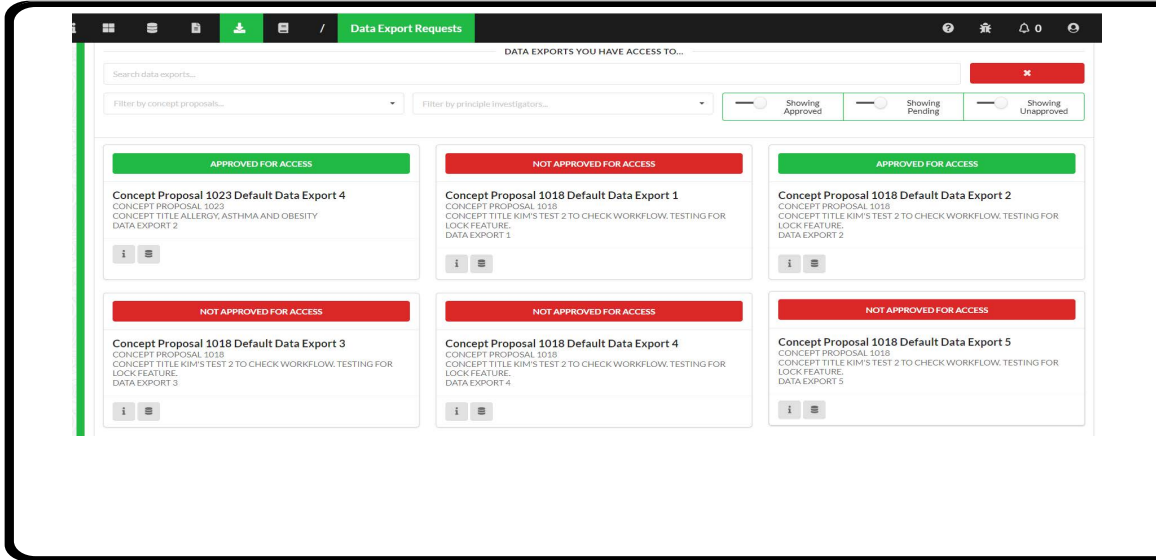

11. Data Export Requests use a green/yellow/red labelling system to denote which Data Exports you are approved to download, which requests are currently pending and which requests you cannot currently download. Click on a Data Export tile to go to the Data Export page for that data request within a specific CP.

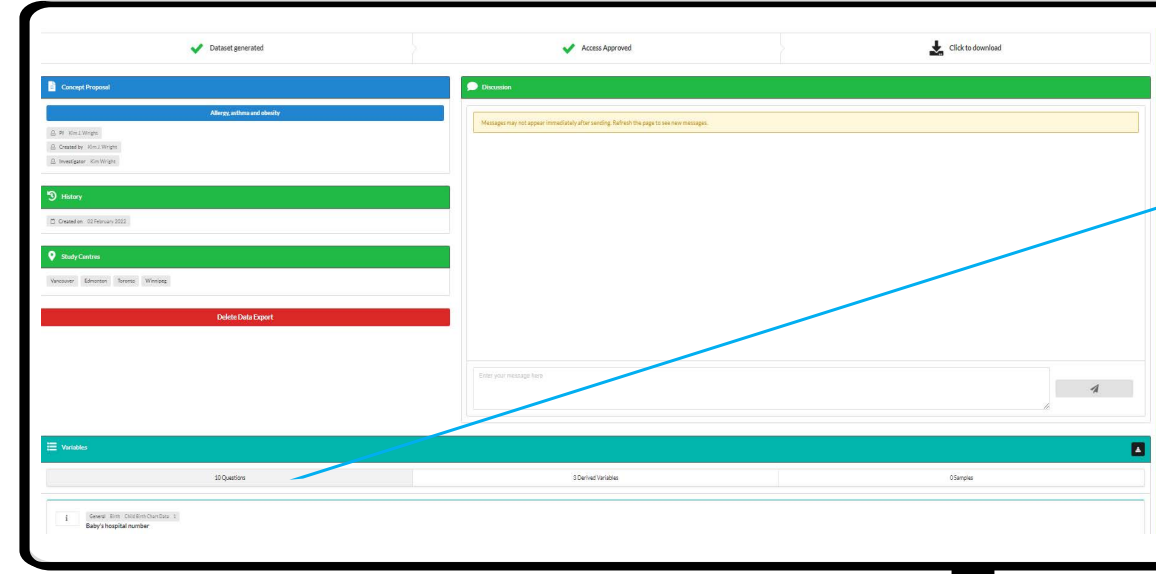

12. The Data Export page shows information about the dataset including the linked variables.

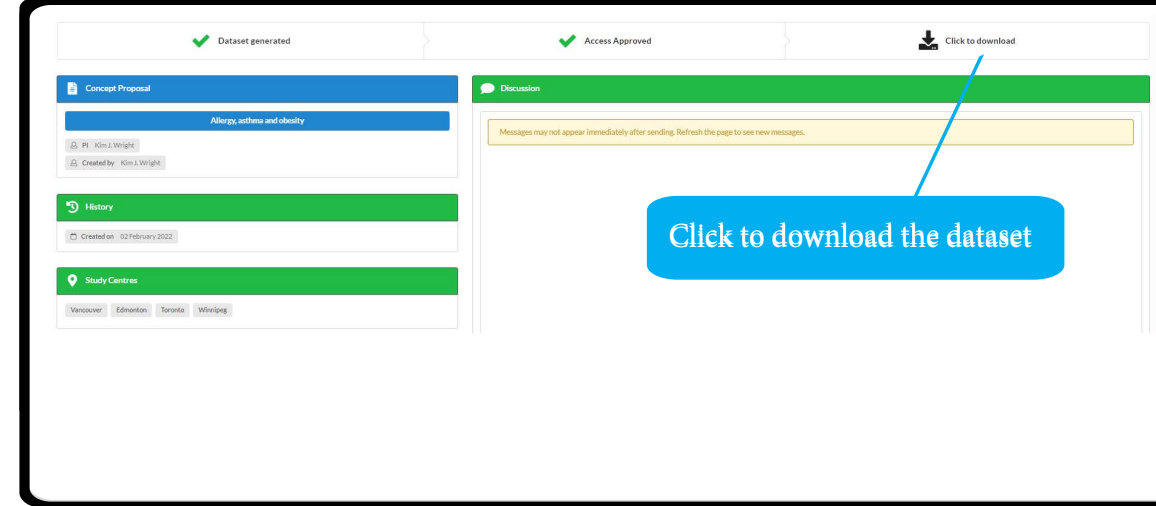

13. The PI of the CP is approved to download all data exports associated with the CP. PI's may select **Click to Download** to download the dataset.

Co-I's must be approved to download datasets. Co-I's may follow Steps 5-8 above to request access to data.

Create a new Data Export Request to download a subset of approved variables

An approved Data Export Request is required to download CHILD data

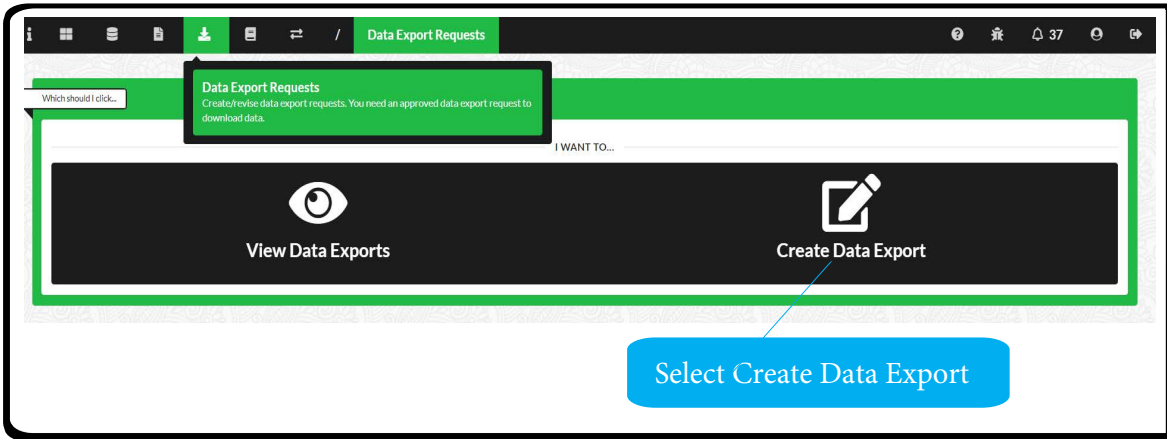

14. Investigators may also create a new Data Export to download a subset of approved variables from an existing CP.

Click the Data Export Requests tab or icon and select **Create Data Export**.

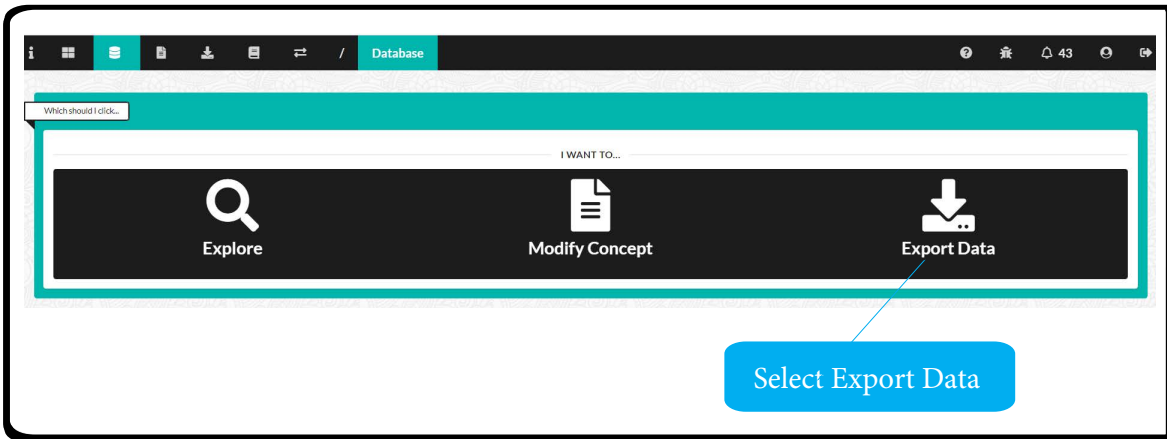

15. Select **Export Data**.

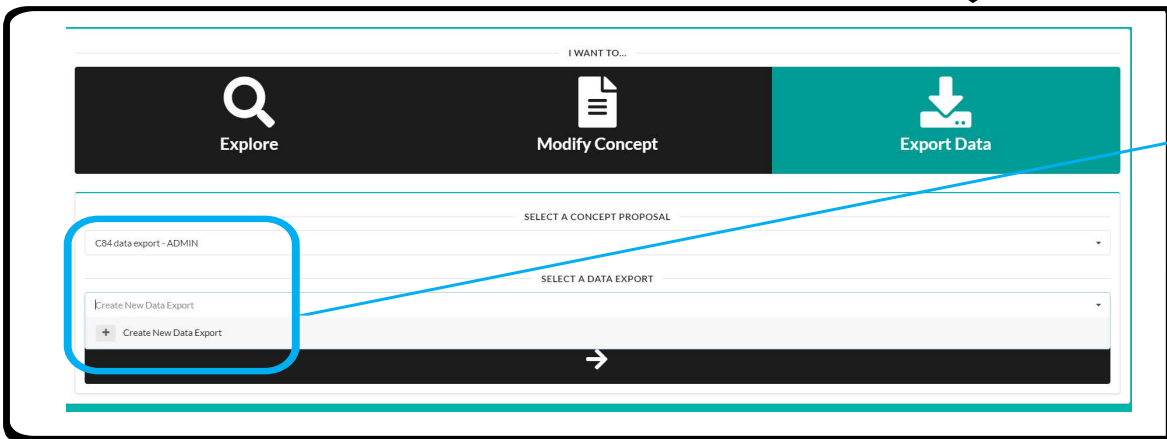

16. Select an approved Concept Proposal. Only CPs that are approved and that you have access to can be selected.

Select **Create New Data Export** and click the Proceed arrow.

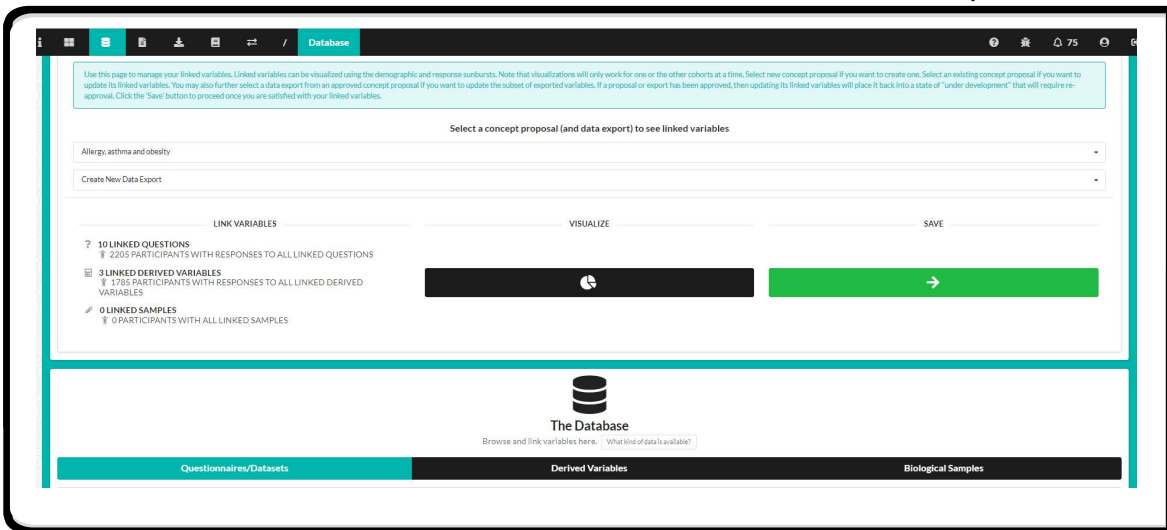

17. You will be taken to the main CHILddb database page.

Scroll down the page to see the approved variables in the CP.

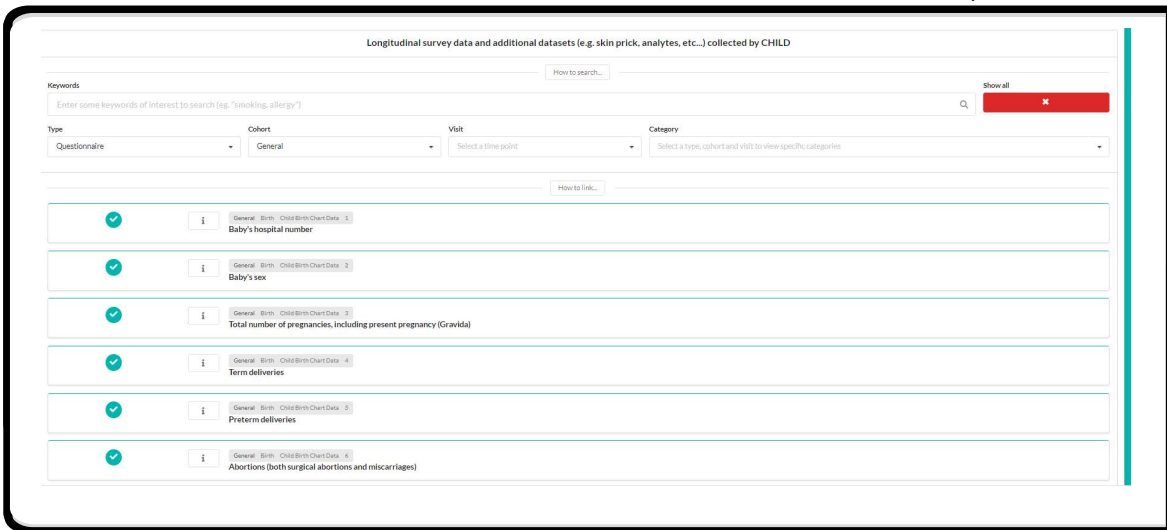

18. You may select a subset of the approved variables for your new Data Export.

Use the toggle button to show only the approved variables for your CP.

Longitudinal survey data and additional datasets (e.g. skin prick, analytes, etc...) collected by CHILD

Keywords

Enter some keywords of interest to search (eg. "smoking, allergy")

Type: Questionnaire Cohort: General Visit: Select a time point Category: Select a type, cohort and visit to view specific categories

How to link...

<input checked="" type="checkbox"/>	<input type="button" value="i"/>	General - Birth - Child Birth Chart Data - 1 Baby's hospital number
<input checked="" type="checkbox"/>	<input type="button" value="i"/>	General - Birth - Child Birth Chart Data - 2 Baby's sex
<input checked="" type="checkbox"/>	<input type="button" value="i"/>	General - Birth - Child Birth Chart Data - 3 Total number of pregnancies, including present pregnancy (Gravida)
<input checked="" type="checkbox"/>	<input type="button" value="i"/>	General - Birth - Child Birth Chart Data - 4 Term deliveries
<input checked="" type="checkbox"/>	<input type="button" value="i"/>	General - Birth - Child Birth Chart Data - 5 Preterm deliveries
<input checked="" type="checkbox"/>	<input type="button" value="i"/>	General - Birth - Child Birth Chart Data - 6 Abortions (both surgical abortions and miscarriages)

19. Select a subset of approved variables for your new Data Export Request.

You can either:

- select to show all the approved variables as 'linked' (teal check mark turned on) and click to de-select the variables you don't want OR
- select to show all the approved variables as 'unlinked' (no check mark) and click to select the variables you want

Database

Use this page to manage your linked variables. Linked variables can be visualized using the demographic and response sunbursts. Note that visualizations will only work for one or the other cohorts at a time. Select new concept proposal if you want to create one. Select an existing concept proposal if you want to update its linked variables. You may also further select a data export from an approved concept proposal if you want to update the subset of exported variables. If a proposal or export has been approved, then updating its linked variables will place it back into a state of "under development" that will require re-approval. Click the 'Save' button to proceed once you are satisfied with your linked variables.

Select a concept proposal (and data export) to see linked variables

Allergy, asthma and obesity

Create New Data Export

LINK VARIABLES VISUALIZE SAVE

8 LINKED QUESTIONS
2417 PARTICIPANTS WITH RESPONSES TO ALL LINKED QUESTIONS

3 LINKED DERIVED VARIABLES
2705 PARTICIPANTS WITH RESPONSES TO ALL LINKED DERIVED VARIABLES

0 LINKED SAMPLES
0 PARTICIPANTS WITH ALL LINKED SAMPLES

CREATE A NEW DATA EXPORT FOR YOUR SELECTED CONCEPT PROPOSAL?

Enter a data export name

Data subset for co-I

Submit data export request

20. Click **Save** to save the new Data Export.

A pop-up message will prompt you to enter a name for your new Data Export. Click **Submit data export request**.

Dataset generated Access request pending Click to download

Concept Proposal

New DE test

PI: Not assigned Created by: Kim Wright

History

Created on: 14 March 2022

Study Centres

Vancouver Edmonton Toronto Winnipeg

Discussion

Messages may not appear immediately after sending. Refresh the page to see new messages.

21. A PI is approved for all new DE requests associated with a CP. A co-I will receive a yellow alert indicating the request for the new Data Export is pending.

When a co-I is approved or denied access to a dataset, the co-I will receive an email and a notification in CHILddb.

For questions about downloading data, contact child@mcmaster.ca.